

**ICBCW24/S**

**FEATURES**

Gentle heat warms cups, dishes

50 lb. capacity - room for 40 cups!

Hidden interior control panel

Removable non-slip mat

Push to open

Black glass and stainless steel options

Rigorously tested in our U.S. manufacturing facilities for decades of use



**PRODUCT SPECIFICATIONS**

Model	ICBCW24/S
Dimensions	597 mm W x 140 mm H x 533 mm D
Weight	60 lb
Electrical Supply	220-240 VAC, 50/60 Hz
Electrical Service	10 amp dedicated circuit
Overall Capacity	0.8 cu ft
Power Cord Length	3 feet

**ELECTRICAL**

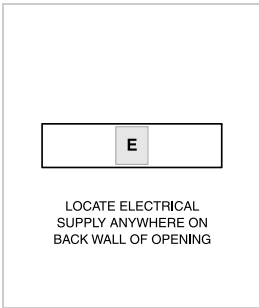

**DIMENSIONS**

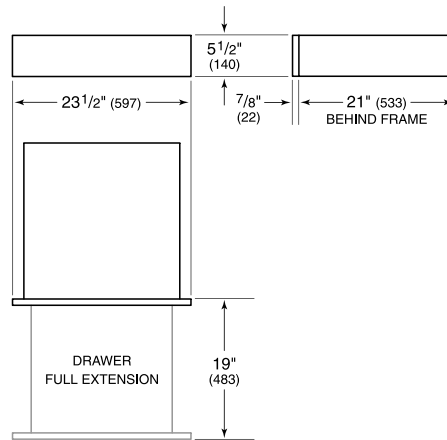

**FLUSH INSTALLATION**

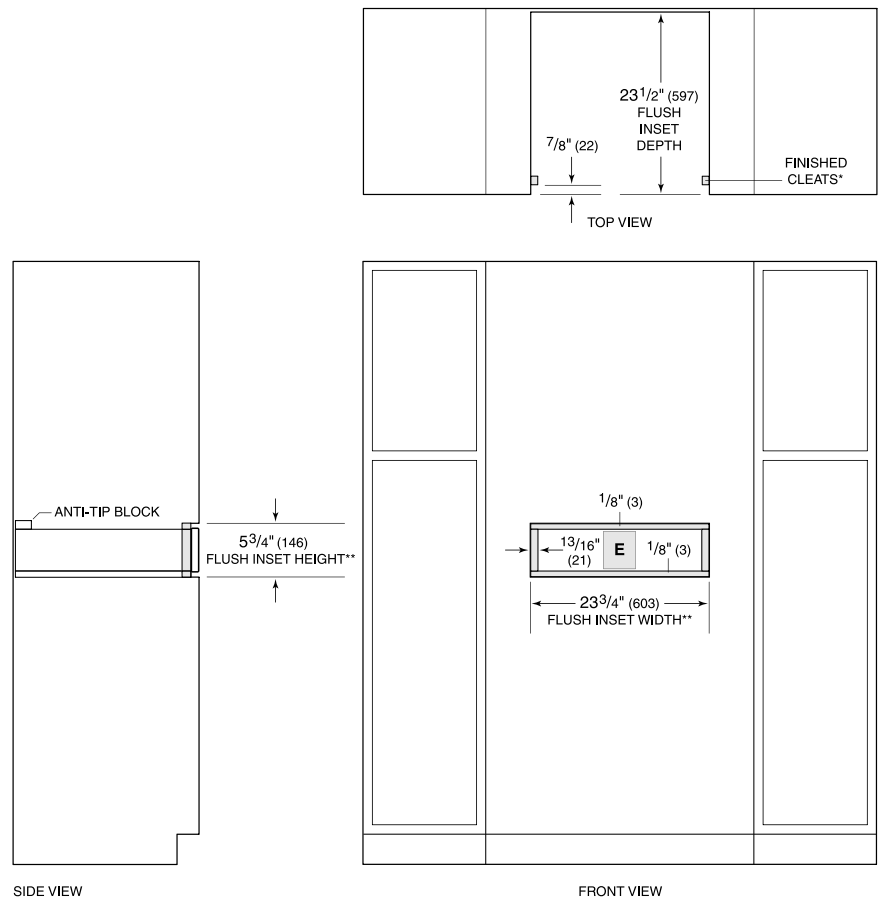

\*Will be visible and should be finished to match cabinetry.  
 \*\*Dimension provides minimum reveals.